

Static/Reaction Square Drive Mounting TORQUE SENSOR

DTD-S Series

DESCRIPTION

The DTD-S series of Static/Reaction Torque Sensors have been designed specifically for the measurement of direct torque, and is particularly suited for use in calibrating or testing Torque Tools in a QA environment. All ranges are constructed from stainless steel and are environmentally protected to IP65.

The sensor is provided with an integral, robust bayonet lock military connector for quick and easy connection purposes.

Other styles and ranges are available and can be designed specifically to meet a particular applications requirement (please consult our Applications Department).

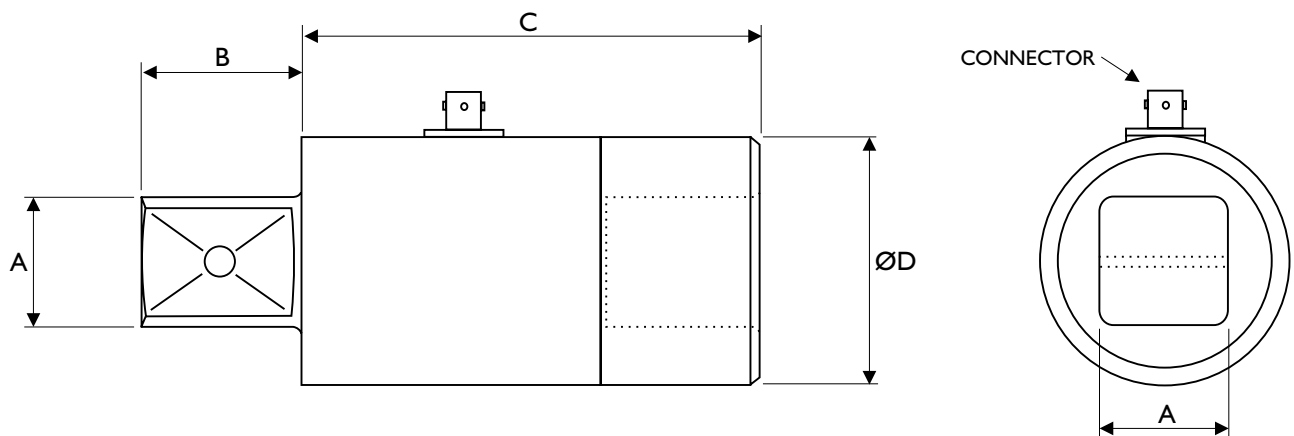

RANGE (Nm)	Square Drive A	B	C	ØD
10	0.250 inch	7.5	48	25
20	0.250 inch	7.5	48	25
50	0.375 inch	11.5	58	35
100	0.500 inch	15.5	58	35
500	0.750 inch	23	79	54
1000	1.000 inch	28	79	54
2000	1.500 inch	38	95	70
5000	2.000 inch	45	130	90
10,000	2.500 inch	55	165	110
20,000	3.000 inch	68	212	130
50,000	3.500 inch	79	185	180

CHARACTERISTICS	DTD-S	UNITS
Range:	10, 20, 50, 100, 500, 1000, 2000, 5000, 10000, 20000, 50000	Nm
Excitation Voltage:	10 (15 Max.)	VDC or VAC
Sensitivity:	2 nominal, 1.5 on 50,000Nm	mV/V
Overload Protection:	150	±%FSO
Non-Linearity:	<0.25	±%FSO
Repeatability:	<0.15	±%FSO
Hysteresis:	<0.25	%FSO
Temperature Range	Operating: -20 to +80	°C
	Compensated: +20 to +70	°C
Temperature Effects	On Zero: <0.010	±%FSO/°C
	On Output: <0.010	±Reading/°C
Bridge Resistance:	700 nominal	ohms
Drive Size:	See Dimension Table Above	
Environmental Protection:	IP65	

Transducer Specialists...

APPLIED MEASUREMENTS LIMITED

Issue 10/05



3 MERCURY HOUSE - CALLEVA PARK - ALDERMASTON - BERKSHIRE - RG7 8PN - UK

Tel: (+44) 0118 981 7339 Fax: (+44) 0118 981 9121 email: info@appmeas.co.uk Internet: www.appmeas.co.uk